

Description	Part No.	Description	Part No.
Rubber Pad	36701	Sear	36725
Cover Plug	36702	Advance Bar	36726
Spring, Sear Holder	36703	Spring, Advance Bar	36727
Spring Firing	36704	Trigger	36728
Firing Pin Nut	36705	Lever Seat	36729
Firing Pin Return Spring	36706	Hollow Pin	36730
Firing Pin Ring	36707	Threaded Pin	36731
Firing Pin	36708	Screw (M6X18)	36732
Sear Tube	36709	Firing Sleeve Bar	36733
Body	36710	Magazine Catch Spring	36734
Steel Liner	36711	Steel Ball (Φ 5)	36735
Stop	36712	Annular Spring	36736
Piston Sleeve	36713	Steel Ball (Φ 6)	36737
<b>Piston Assembly</b>	<b>36714</b>	Shear Clip	36738
Piston Ring	36715	Supporting Angle Piece	36739
Guide	36716	Push Pin	36741
Base Plate	36717	Press Spring	36742
Trigger Spring	36718	Ball (Φ 3)	36743
Screw (M6X12)	36719	Positioning Lever	36745
Pin (A4X18)	36720	Covering Plate	36746
Screw (M16X10)	36721	Screw (M6X8)	36747
Lever Spring	36722	<b>Firing Pin Assembly</b>	<b>36748</b>
Firing Lever	36723	<b>Covering Plate Assembly</b>	<b>36749</b>
Sear Spring	36724	<b>Rubber Pad Assembly</b>	<b>36750</b>

**Firing Pin Assembly 36748**

Firing Pin Nut = 36705  
 Firing Pin Return Spring = 36706  
 Firing Pin Ring = 36707  
 Firing Pin = 36708

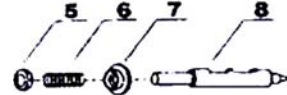

**Covering Plate Assembly 36749**

Covering Plate = 36746  
 Positioning Lever = 36745  
 Ball (Φ 3) = 36743  
 Press Spring = 36742

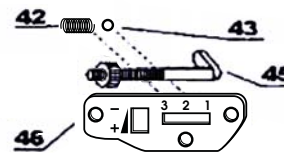

**Rubber Pad Assembly 36750**

Rubber Pad = 36701  
 Supporting Angle Piece = 36739  
 Trigger Spring = 36718  
 Screw (M6X12) = 36719  
 2 X Screw (M16X10) = 36721  
 Pin (A4X18) = 36720  
 Lever Spring = 36722  
 Firing Lever = 36723

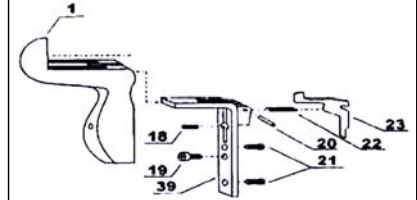

**Piston Assembly 36714 (piston/ring)**

Piston Ring = 36715

