

Description	Part No.	Description	Part No.
Rubber Pad	36301	Hollow Pin	36330
Cover Plug	36302	Threaded Pin	36331
Spring, Sear Holder	36303	Screw (M6X18)	36332
Spring Firing	36304	Firing Sleeve Bar	36333
Firing Pin Nut	36305	Magazine Catch Spring	36334
Firing Pin Return Spring	36306	Steel Ball (Φ 5)	36335
Firing Pin Ring	36307	Annular Spring	36336
Firing Pin	36308	Steel Ball (Φ 6)	36337
Sear Tube	36309	Supporting Angle Piece	36339
Body	36310	Press Spring	36342
Steel Liner	36311	Ball (Φ 3)	36343
Stop	36312	Positioning Lever	36345
Piston Sleeve	36313	Covering Plate	36346
Piston Assembly	36314	Lock washer (M4)	36347
Piston Ring	36315	Bolt (M4X6)	36348
Trigger Spring	36318	Firing Pin Assembly	36349
Screw (M6X12)	36319	Covering Plate Assembly	36350
Pin (A4X18)	36320	Rubber Pad Assembly	36351
Screw (M16X10)	36321	Stop Ring	36352
Lever Spring	36322	Retaining Ring	36353
Firing Lever	36323	Plastic Ring	36354
Sear Spring	36324	Rubber Ring (24mm)	36355
Sear	36325	Base	36356
Advance Bar	36326	Guide	36357
Spring, Advance Bar	36327	Guide lock	36358
Trigger	36328		
Lever Seat	36329		

Firing Pin Assembly 36349

Firing Pin Nut = 36305
 Firing Pin Return Spring = 36306
 Firing Pin Ring = 36307
 Firing Pin = 36308

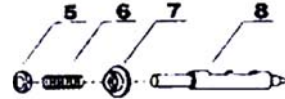

Covering Plate Assembly 36350

Covering Plate = 36346
 Positioning Lever = 36345
 Ball (Φ 3) = 36343
 Press Spring = 36342

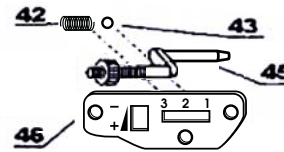

Rubber Pad Assembly 36351

Rubber Pad = 36301
 Supporting Angle Piece = 36339
 Trigger Spring = 36318
 Screw (M6X12) = 36319
 2 X Screw (M16X10) = 36321
 Pin (A4X18) = 36320
 Lever Spring = 36322
 Firing Lever = 36323

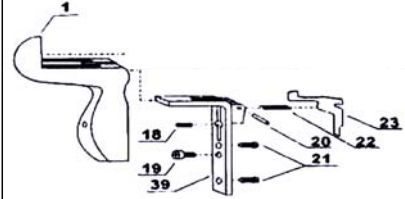

Piston Assembly 36314 (piston/ring)

Piston Ring = 36315

