

# UCAN

## FASTENING PRODUCTS

### U-DRILLS® Application Guide



#### Specialized

##### Cement Board Screws

Self Drilling - RUSPRO® (CBT)  
Spoon Point - RUSPRO® (CBS)



##### Framing Screws

Self Tapping / Socket Pan Head - RUSPRO® (SRP)  
Self Tapping / Soc. Flat Undercut - RUSPRO® (SRU)  
Self Tapping / Soc. Flat Type "A" - RUSPRO® (SRF)



##### Machine Screws

Square Socket Truss Head - RUSPRO® (MST)  
Square Socket Round Head - RUSPRO® (MSR)



##### Tapping 18-8 S.S. Passivated

Square Socket Head (STA-SS)  
Square Socket Head/EPDM (STA-SSN)



##### Eye Lag Screws

Eye Lag for Metal - Zinc Plated (TLS)  
Eye Lag for Metal/EPDM Washer-Zinc Plated (TLS-N)  
Eye Lag for Wood - Zinc Plated (ELS)



##### Side Lap / HVAC Screws

Hex Washer Head - Zinc Plated (UTH)



#### Self Drilling

##### Zinc Plated - Steel to Steel

Hex Washer Head (THW)  
Hex Washer Head/Bonded EPDM (THW-N)  
Socket Pan Head (TSP)  
Phillips Pan Head (TPP)  
Phillips Modified Truss Head (TPW)  
Oval Countersink Head (TPO/TSO)  
Flat Countersink Head (TSF)

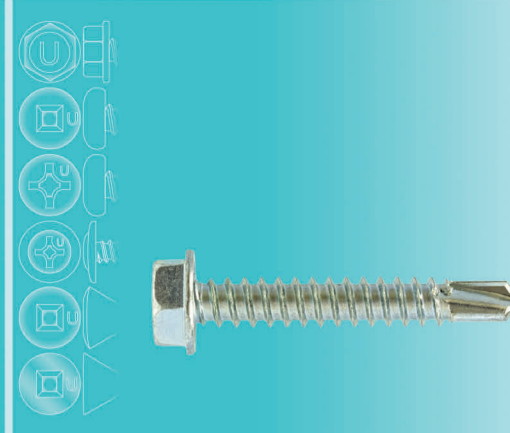

##### RUSPRO® Coated

Hex Washer Head (TRH)  
Hex Washer Head/Bonded EPDM (TRH-N)  
Socket Pan Head (TRP)

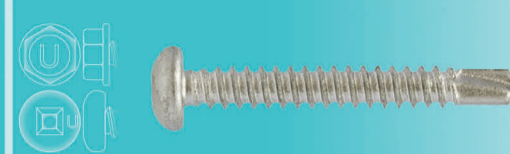

##### Zinc Plated - Stitch Lapping

Hex Washer Head (SHW)  
Hex Washer Head/Bonded EPDM (SHW-N)



##### RUSPRO® - 410 Stainless Steel

Hex Washer Head (TRH-SS)  
Hex Washer Head/Bonded EPDM (TRH-SSN)  
Socket Pan Head (TRP-SS)  
Flat Countersink Head (TRF-SS)  
Hex Washer Head - Stitch Lapping (SRH-SS/N)



##### Zinc Plated - Wood to Steel

Socket Wafer Head with Reamer (TSW-R)  
Socket Wafer Head without Reamer (TSW)



##### RUSPRO® Coated Heavy Gauge Applications

Hex Washer Head (TRH-4/5)  
Hex Washer Head/Bonded EPDM (TRH-4/5N)  
Hex Washer Head - Extra Drill Capacity (TRH-M5)  
Mighty Mole™ - Hex Washer Head (TRH-M8)  
19mm Drill Capacity

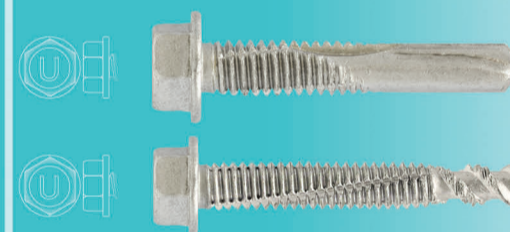

#### Self Piercing

##### Zinc Plated - Steel to Steel

Hex Washer Head (STH)  
Hex Washer Head/Painted Head (STH-W)  
Socket Pan Head (STP)  
Phillips Modified Truss Head (SPW)  
Phillips Modified Truss Head/Painted Head (SPW-W)



##### Screw Characteristics

Fastener Size	Minimum Tensile (lbs)	Minimum Fastener Torque Strength (in. x lbs)	Fastener Shear (lbs)
8-18	1575	42	1000
10-16	2100	61	1400
10-24	2350	65	1500
12-14	2800	92	2000
1/4-14	3850	150	2600
1/4-20	4275	168	2700

##### Strength Characteristics

Fastener Size	Minimum Breaking Torque (in/lbs)	Tensile Strength (lbs)	Shear Strength (lbs)	Recommended Drilling Speed (rpm)
#6	30	1,102	652	1,800 - 2,500
#8	42	1,529	967	
#10	65	2,181	1,439	
#12	96	3,305	2,068	1,000 - 1,800
1/4-14	150	4,275	2,540	

##### Corrosion Protection

**Zinc Plating**  
Plating thickness (0.0002" - 0.00035")

**RUSPRO® Coating**  
The RUSPRO® multi layer coating provides outstanding resistance against road salt, humidity, solvents and other corrosive elements.

- Exceptional corrosion resistance
- Excellent acid (SO<sub>2</sub>) resistance
- Bonded multi layer coating to resist abrasion

Salt Spray Resistance (ASTM B117 - 03)  
1,000 hours (5-10% red rust)

Kesternich Test DIN 50028 - (2.0 liter SO<sub>2</sub>)  
15-20 cycles (<10% red rust)

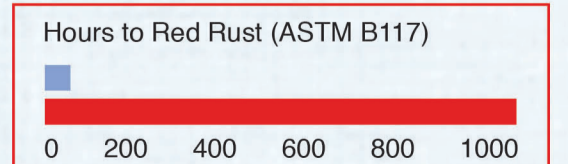

**Note:** This guide is only a visual reference to some typical anchoring applications. Prior to using any fastener, verify its suitability based on application specific conditions. Refer to UCAN's Disclaimer of Warranty and Liability at ucanfast.com

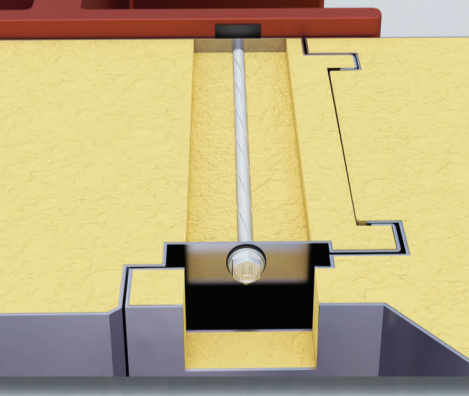
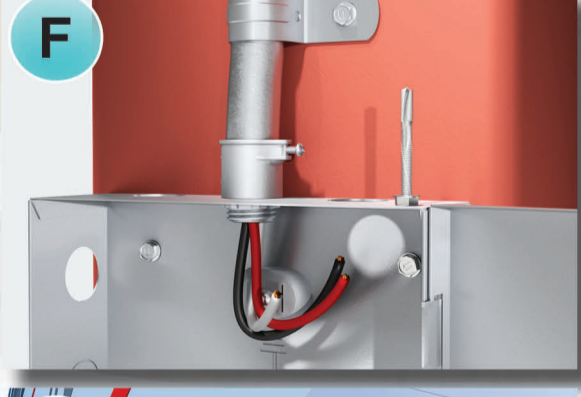
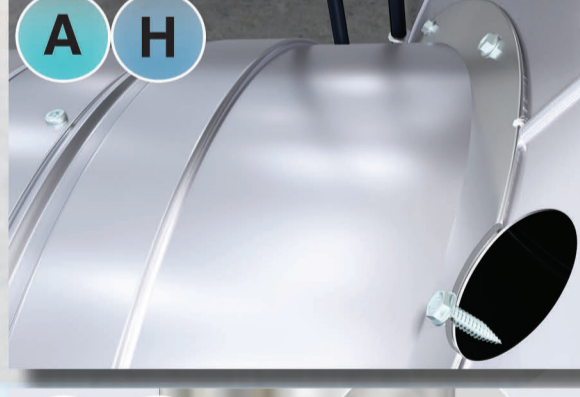
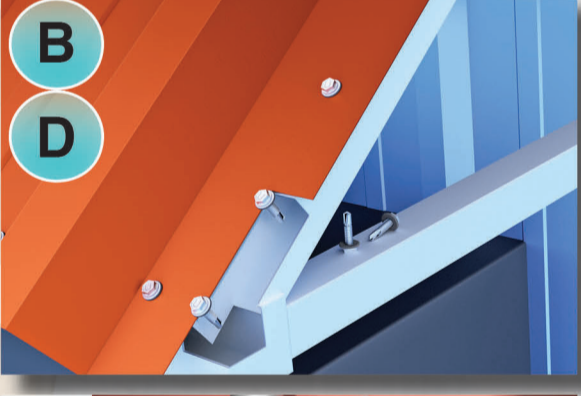
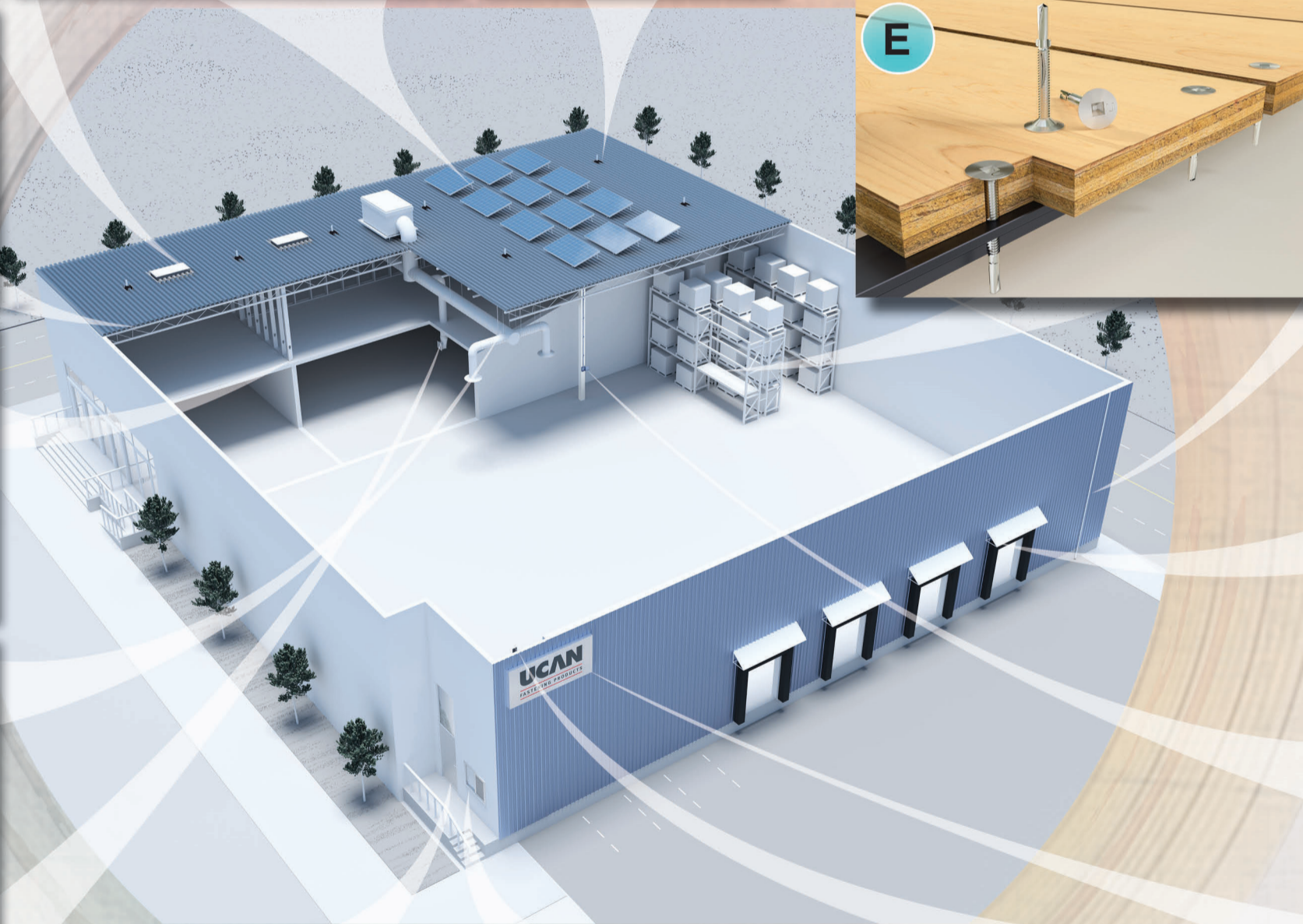
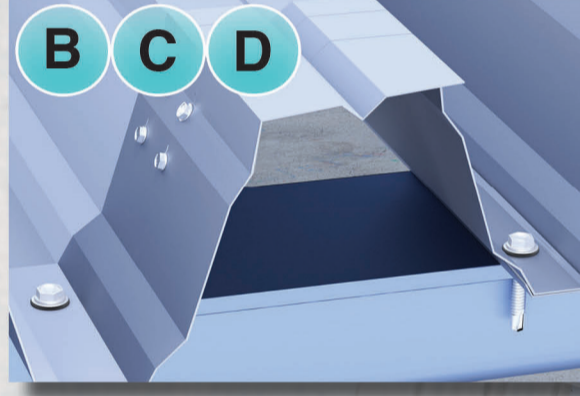
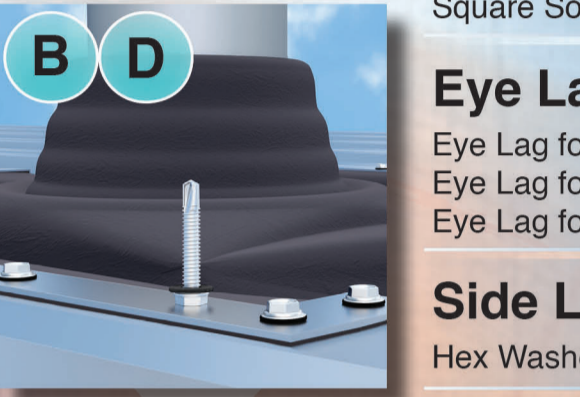
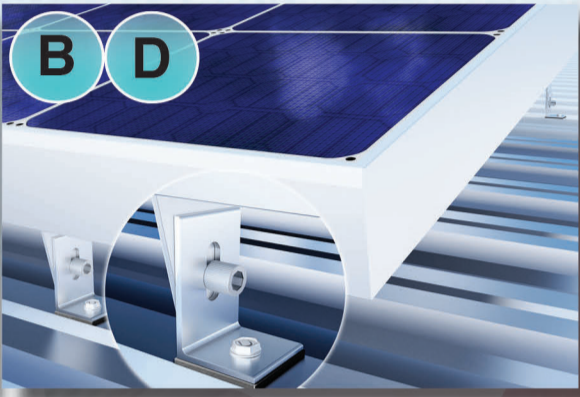
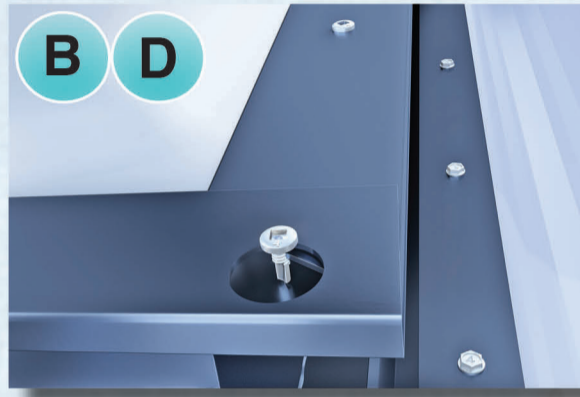

##### BONDED EPDM SEALING WASHERS

Type I - Galvanized Steel (SW)  
Type II - Zinc Clad (CW)  
Type III - Stainless Steel (SW-SS)



UCAN offers automated assembly of many types of screw with bonded EPDM washers. Please call for a quote. Capacity: Screw diameter # 8 - 14 Length 3/4" - 2-7/8"

