

Description	Part No.	Description	Part No.
Rubber Pad	36201	Sear	36225
Cover Plug	36202	Advance Bar	36226
Spring, Sear Holder	36203	Spring, Advance Bar	36227
Spring Firing	36204	Trigger	36228
Firing Pin Nut	36205	Lever Seat	36229
Firing Pin Return Spring	36206	Hollow Pin	36230
Firing Pin Ring	36207	Threaded Pin	36231
Firing Pin	36208	Screw (M6X18)	36232
Sear Tube	36209	Firing Sleeve Bar	36233
Body	36210	Magazine Catch Spring	36234
Steel Liner	36211	Steel Ball (Φ 5)	36235
Stop	36212	Annular Spring	36236
Piston Sleeve	36213	Steel Ball (Φ 6)	36237
<b>Piston Assembly</b>	<b>36214</b>	Shear Clip	36238
Piston Ring	36215	Supporting Angle Piece	36239
Guide	36216	<b>Firing Pin Assembly</b>	<b>36248</b>
Base Plate	36217	<b>Rubber Pad Assembly</b>	<b>36250</b>
Trigger Spring	36218		
Screw (M6X12)	36219		
Pin (A4X18)	36220		
Screw (M16X10)	36221		
Lever Spring	36222		
Firing Lever	36223		
Sear Spring	36224		

**Firing Pin Assembly 36248**

- Firing Pin Nut = 36205
- Firing Pin Return Spring = 36206
- Firing Pin Ring = 36207
- Firing Pin = 36208

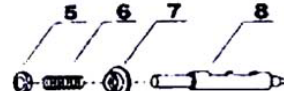

**Piston Assembly 36214 (piston/ring)**

- Piston Ring = 36215

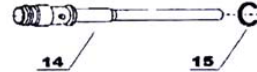

**Rubber Pad Assembly 36250**

- Rubber Pad = 36201
- Supporting Angle Piece = 36239
- Trigger Spring = 36218
- Screw (M6X12) = 36219
- 2 X Screw (M16X10) = 36221
- Pin (A4X18) = 36220
- Lever Spring = 36222
- Firing Lever = 36223

